

Services Nurse Call, Surgery Call, Warden Call, Staff Safety, Access Control, CCTV

Intercall 600	✓
Intercall 700	✓

L722 Infra Red Call Point.

The L722 Infra Red Call Point is similar to the L622 button reset unit, with the additional facilities of an infra red receiver. The unit may be used as part of an Intercall 600 or 700 system and the infra red receiver gives the system true portability with the use of the TIR pendants and STC staff triggers. More information on the TIR range of triggers may be found on page 47. Please refer to page 29 for more information on the L622 Call Point. Please refer to the information contained on page 22 for more information regarding installation and performance of the Infra Red receiver.

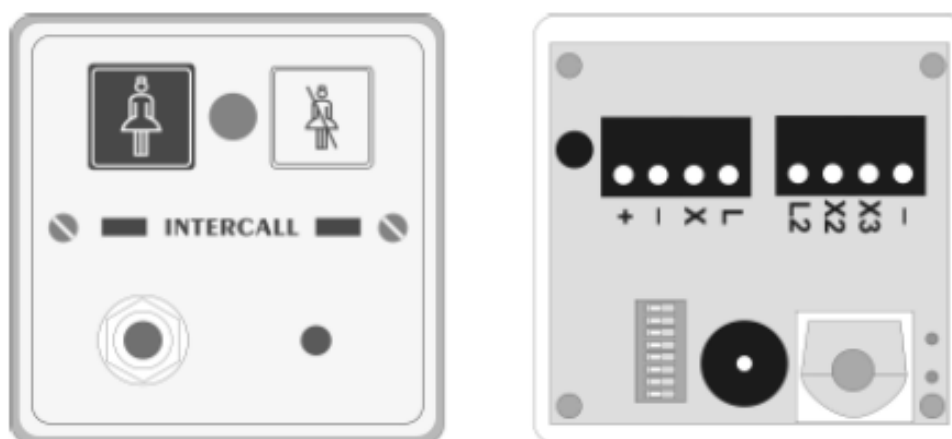

- Network Terminals:** Connect to the Intercall 600 or 700 (2 wire) Network. [+ , -] OBSERVE POLARITY
- X Terminal:** Standard Call Input which automatically generates **Auxiliary Input Text 3**.
This allows the input to have a secondary description, for example 'Ensuite'
- X2 Terminal:** Emergency Call Input which automatically generates **Auxiliary Input Text 4**.
This allows the input to have a secondary description, for example 'Bathroom'
- X3 Terminal:** Reset / Present Input for SRP Slave Reset Points
- L Terminal:** Output signal to drive ceiling pull switches with built in re-assurance lights. *Max load 12v 10mA*
- L2 Terminal:** Output signal to drive Slave Reset Points Green LED. *Max load 12v 10mA*
- Terminal:** Additional Network negative common terminal for auxiliary connections.
- Address Switches:** Set to unique setting between 1 and 215.
- System User-Id:** This feature allows the X1 and X2 input(s) to have a secondary description, for example 'En-suite' or 'Ceiling Pull Cord' when activated – *Only available when using L717.*
- Re-assurance LED:**
 - Slow Red flashing – Standard Call
 - Faster Red flashing – Priority Call
 - Slow Red/Green flashing – Assistance Call
 - Rapid Red flashing – Emergency/Crash Call
 - Green flashing - Accepted Call – Staff on their way
 - Constant Green – Nurse Present Mode
- IR Receiver:** Typically, the unit will cover a room 6m x 6m. **Important: Refer to notes on Page 22.**
- Pear lead Socket:** Industry standard socket that will accept any normally open switch.
- Installation:** Flush or surface mount in standard 'single size' electrical backbox.
- Size & Weights:** 80 x 80 x 40 mm, 70g